

EB-STERIL SA

CONSULTING ENGINEERING MANUFACTURING

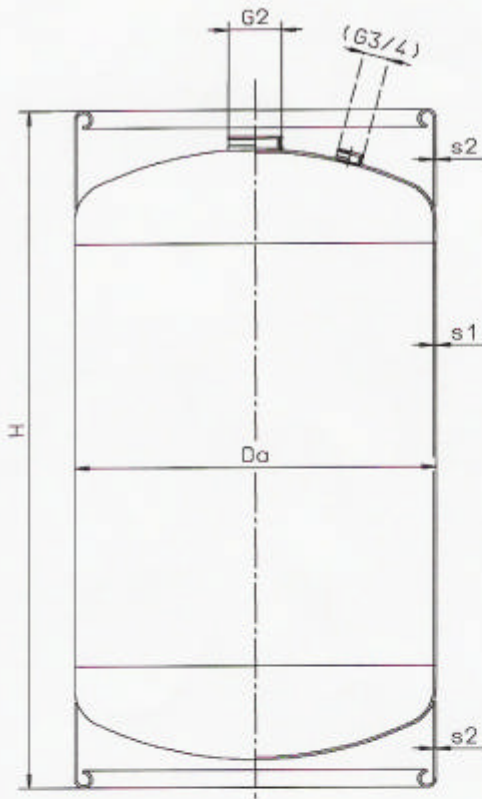

STAINLESS STEEL CONTAINERS (Drums) LT 10, LT 20, LT 30, LT 50, LT 100, LT 200

Robust stainless steel container for use as returnable packaging

International approval for transport of hazardous goods under UN 1A1W/X2.0/900

Maximum service pressure: 5 bar

Container completely made of stainless steel grade AISI 304

LT 10, LT 20, LT 30 and LT 50 with footing for stacking

Container equipment:

Type LTA: Central bung 2" with screw-cap, seals of PTFE or Viton

Type LTB: Additional bung 3/4" with screw cap

Type	volume (l)	Da (mm)	H (mm)	s ₁ (mm)	s ₂ (mm)	tara (kg)
LT 10	12	278	315	1,5	1,5	6
LT 20	22	278	470	1,5	1,5	7
LT 30	33	363	435	1,5	2,0	10
LT 50	54	363	630	1,5	2,0	14
LT 100	110	457	880	2,0	2,5	30
LT 200	225	600	960	2,0	2,5	43

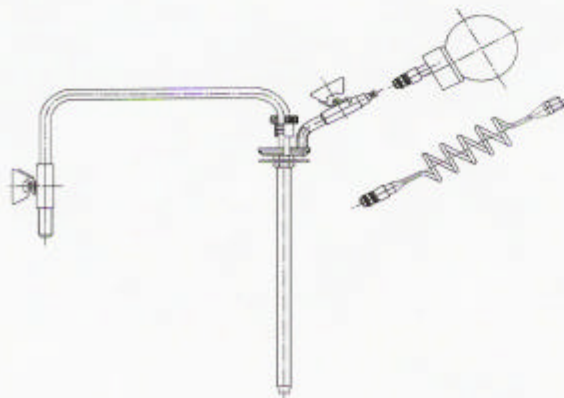

Accessories:

Dispenser system type ET
(see separate data sheet)